

SECTIUNE TRANSVERSALA / CROSS SECTION

Scara / Scale 1:100

SECTIUNE TRANSVERSALA / CROSS SECTION

Scara / Scale 1:100

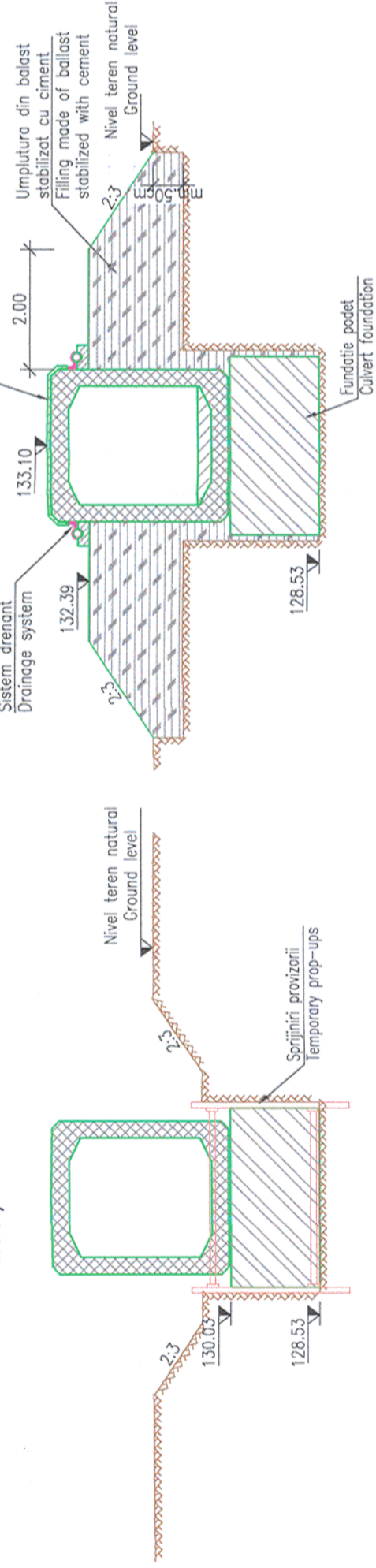

- ETAPA I:
- Se amenajeaza drumul de acces, platforma tehnologica si organizarea de santier
  - Se traseaza si picheteaza axele liniilor pentru traseul nou proiectat si infrastructurilor podetului nou.
  - Se executa sapatura cu sprijiniri pentru realizarea fundatiilor noi (podet si aripi).
  - Se betoneaza fundatiile podetului si aripilor si se scot sprijiniri.
  - Se aseaza elementele prefabricate tip C2EN si tip AZEN pe fundatiile monolite si se trateaza resturile dintr-un element prefabricat conform detaliilor din proiect.
  - Pe suprafata din beton in contact cu pamantul se vor aplica 2 straturi de emulsie din bitum filenizat.

- STAGE I:
- Arranging the access road, technological platform and site organization.
  - Marking-out and pegging-out the axes of the lines for the new designed route and the new culvert infrastructures.
  - Making the excavation with propping for executing the new foundations (culvert and wings).
  - Concreting the foundations of the culvert and of the wings and removing the propping.
  - Placed the precast elements type C2EN and type AZEN on the cast-in-place foundations and treating the joints between the precast elements according to the design.
  - Applying 2 layers of filler bitumen emulsion on the concrete surfaces coming in contact with earth.

- ETAPA II:
- Se executa sapatura de minim 50cm sub nivelul terenului natural.
  - Se executa umplutura din balast stabilizat cu ciment la cota.
  - Se executa fundatia drenului conform detaliilor din proiect.
  - Se executa hidroizolatia si sistemul drenant (geodren, geotextil, tub si material drenant).
  - Se executa sapa hidroizolanta la extradosul cadrilor.
  - Se executa perul in podet si in aripi.
  - Se executa saltuca din anrocamente la capatul din amonte si aval a podetului.
  - Se amenajeaza albia podetului in amonte si aval, conform proiectului.

- STAGE II:
- Making the excavation of min 50cm under the level of the natural ground.
  - Executing the filling made of ballast stabilized with cement at the dimension.
  - Executing the foundation of the drain according to the details in the design.
  - Executing the waterproofing and the draining system (geo-drain, geo-textile, tube and draining material).
  - Executing the waterproofing protected by watertight blanket at the extrados of the frames.
  - Executing the pitching in the culvert and between the wings.
  - Executing the mattress of riprap at the upstream and downstream end of the culvert.
  - Arranging the riverbed of the upstream and downstream culvert, according to the design.

SECTIUNE LONGITUDINALA A-A/ A-A LONGITUDINAL SECTION

Scara/Scale 1:200

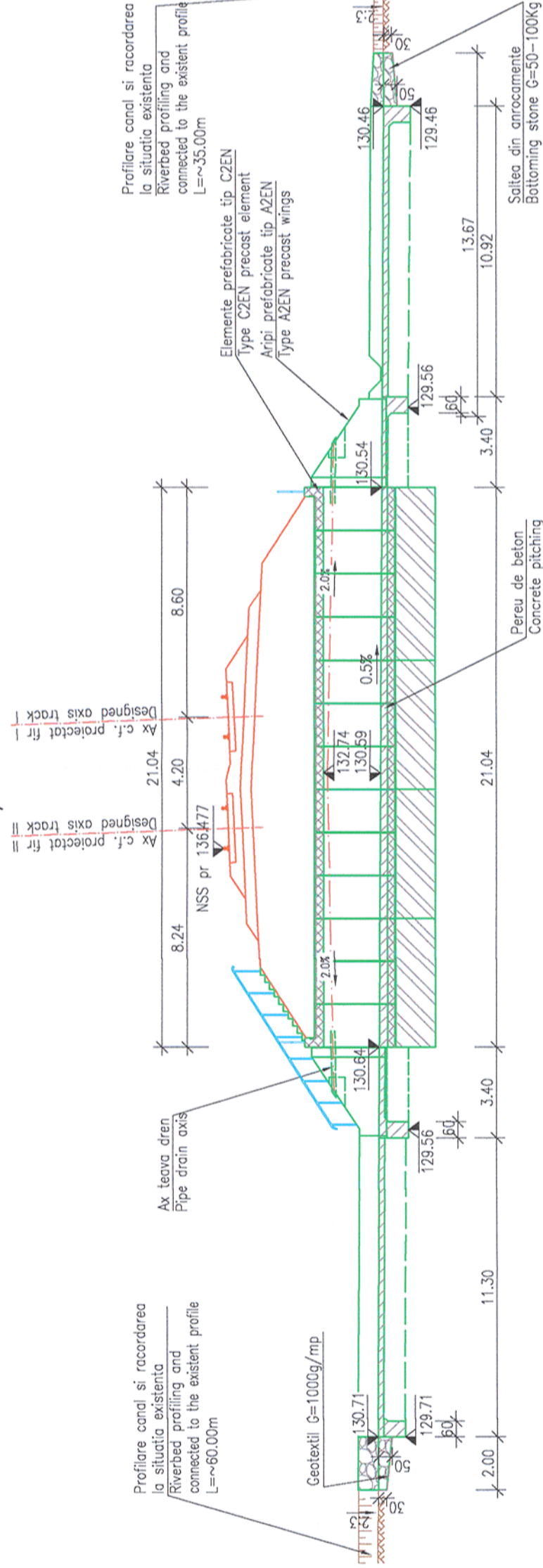

Prezentul plan anuleaza si inlocuieste versiunea anterioara  
This plan cancels and replaces previous version



Verificator / Expert Checker / Expert		Semnatura Signature	Referat / Expertiza Report / Expertise
--	--	------------------------	---

**European Investment Bank**

**MINISTERUL TRANSPORTURILOR**

**BENEFICIAR / BENEFICIARY :**

**COMPANIA NATIONALA DE CAI FERATE "CFR" SA**

**PROIECTANT / DESIGNER:**

Aprobat Approved	Sef de echipa Team leader	C. Teodorescu	01.2013	Semnatura Signature
Verificat Checked	Expert Cheie Key Expert	R. Tudorascu	01.2013	

Subcontractant / Subcontractor

**VIOTOP**

Aprobat Approved	Adjunct Sef de echipa Deputy Team leader	A.M. Baicu	01.2013
Proiectat Designed	Inginer Engineer	F. Ioanidi	01.2013

"Reabilitarea liniei c.f. Frontieră - Curtici - Simeria, parte componentă a coridorului IV Pan - European pentru circulația trenurilor cu viteză maximă de 160 km/h"

Tronsoanel 2-A : km 614 - cap Y Bărzava

"Rehabilitation of the Railway Line Border - Curtici - Simeria, component Part of the IV Pan - European Corridor for the Trains Circulation with maximum speed of 160 km/h"

Section 2-A : km 614 - end Y Bărzava

Denumire desen / Drawing name:  
**TEHNOLOGIE DE EXECUTIE / EXECUTION TECHNOLOGY**  
**PODET / CULVERT KM pr. 580+344**

Scara / Scale 1:200 ; 1:100	Revizia / Revision 1 / 04.2013	Cod desen / Drawing Code PT.02.02.09.PO.13.04	Nr / No 04
--------------------------------	-----------------------------------	--	---------------